

209632 Bracket 209634A,B and 209635A,B Cover Plates

TRADELINE®

INSTALLATION INSTRUCTIONS

APPLICATION

The TRADELINE® 209632 Bracket, purchased separately, can be used to mount the cover plate to a 2 in. x 4 in. vertical or horizontal outlet box.

The TRADELINE® 209634A,B and 209635A,B Cover Plates are designed for use with the T8400 and T8401 Electronic Thermostats and can be used to cover marks left by old thermostats. The Cover Plates are available in two decorator sizes and colors. See Table 1 for specifications.

Table 1. Cover Plate Specifications.

Part Number	Dimensions	Color
209634A	3-7/8 in. (98 mm) x 3-7/8 in. (98 mm)	Taupe
209634B	3-7/8 in. (98 mm) x 3-7/8 in. (98 mm)	Premier White®
209635A	5-3/4 in. (146 mm) x 5-3/4 in. (146 mm)	Taupe
209635B	5-3/4 in. (146 mm) x 5-3/4 in. (146 mm)	Premier White®

INSTALLATION

When Installing this Product...

- 1. Read these instructions carefully. Failure to follow them could damage the product or cause a hazardous condition.
- 2. Check the ratings given in the instructions and on the product to make sure the product is suitable for your application.
- 3. Installer must be a trained, experienced service technician.
- 4. After installation is complete, check out product operation as provided in these instructions.

**CAUTION**
Can cause electrical shock or equipment damage.
Disconnect power supply.

Mounting Bracket to Wiring Box
The bracket is designed to mount the cover plate to a 2 in. x 4 in. vertical or horizontal wiring box.

- Mount the bracket as follows (see Fig. 1):
- 1. Remove the mounting screws from the wiring box.
 - 2. Position the bracket over the wiring box.
 - 3. Insert the screws through the bracket and wiring box mounting holes and tighten.
 - 4. Place the cover plate over the bracket.
 - 5. Position the wallplate over the cover plate.
 - 6. Insert the mounting screws (provided with the thermostat) through the mounting holes on the wallplate and the cover plate and tighten.

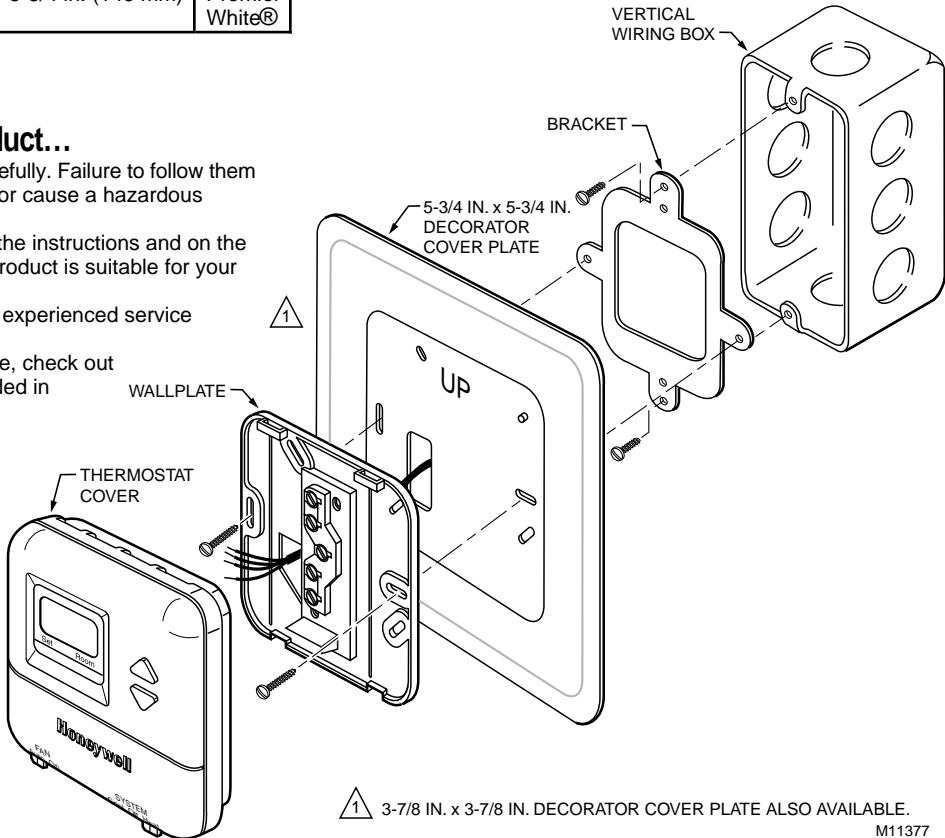

Fig. 1. Mount thermostat, wallplate, cover plate and bracket to wiring box.



Mounting Cover Plate to Wall

Mount the cover plate to the wall as follows (see Fig. 2):

- 1. Position the cover plate on the wall.
- 2. Place the wallplate over the cover plate.
- 3. Insert the mounting screws (provided with the thermostat) through the mounting holes on the wallplate and the cover plate and tighten.

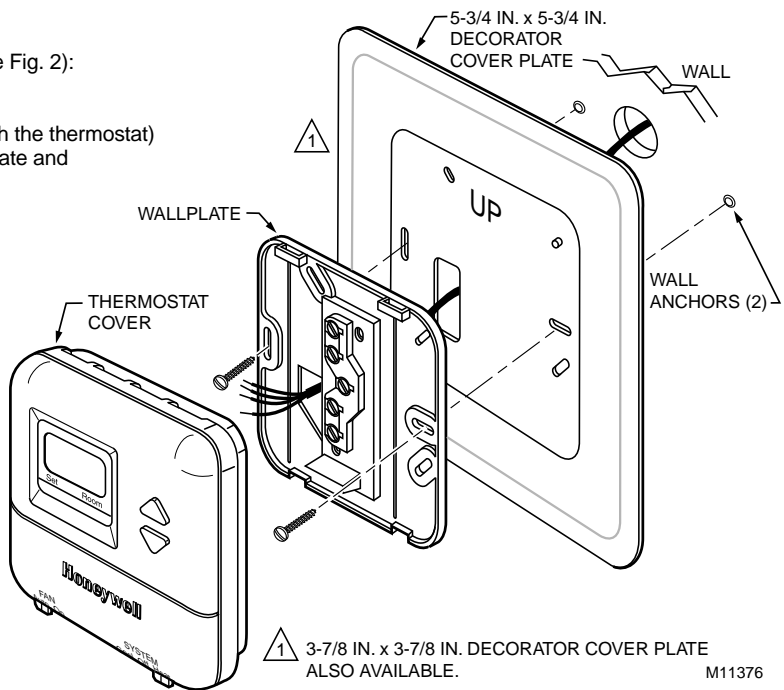

Fig. 2. Mount thermostat, wallplate, and cover plate to wall.

Honeywell

Home and Building Control
Honeywell Inc.
Honeywell Plaza
P.O. Box 524
Minneapolis, MN 55408-0524

Home and Building Control
Honeywell Limited-Honeywell Limitée
155 Gordon Baker Road
North York, Ontario
M2H 3N7

Helping You Control Your World®